

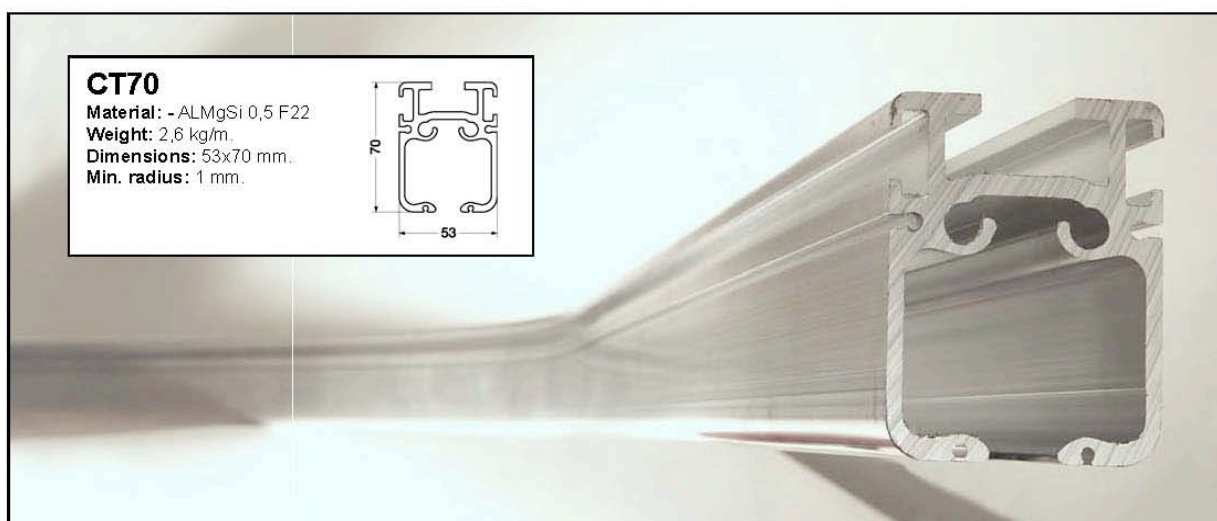

CT 70 CYCLO TRACK RAIL SYSTEM For Cyclorama & Backgrounds



The CT 70 CYCLO TRACK system is based on an extruded profile from high resistant aluminum, therefore wide spans can be accomplished between supports.

The profile is specially shaped to permit a very smooth sliding of curtain rollers, specially in tall installations. The CYCLO TRACK system is comprising also manual or motorized switch systems, to transfer clothes from one rail circuit to another or to a parking section, and motorized cloth loading sections are available on request. Both horizontal and vertical cloth tensioning systems are configured on project bases.



Mod. N° 9055.002.00.001
CT 70 Rail Junction Kit



Mod. N° C110.014.02.000
CT 70 Double Rail Fixing
Flange to upper IPE80, IPE 100 or D Rail
It includes the necessary nuts and washers



Mod. N° 9055.002.00.003
CT 70 "T" Bolt for upper fixing (HS38/17)
It includes the necessary nuts and washers



Mod. N° C100.100
CT 70 Cyc Cloth trolleys (the suggested minimum spacing between trolleys on the Cyc Cloth is 1 trolley every 30cm of cloth) with ball bearing

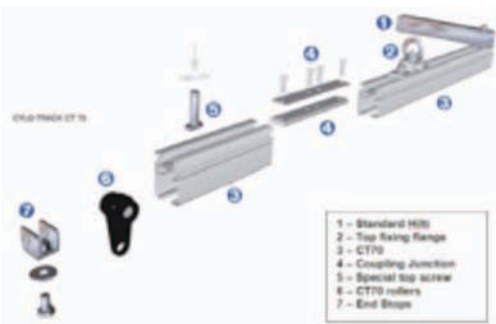

MECHANICAL PROPERTIES CT 70						
Span distance between hanging points	meters	1	1,5	2	2,5	3
	feet	3'3"	4'11"	6'6"	8'2"	9'9"
Point load	N	2354	1461	1088	873	725
	Kg.	224	149	111	89	74
Deflection With max Point Load	mm.	1,82	4.1	7.3	11.4	16.5
	inches	0.07	0.16	0.28	0.44	0.64
Distributed load	N/m	2986	1327	746	478	332
	Kg/m	447	198	111	71.5	49.5
	Lbs/foot	299	132	7.5	48	33
Deflection With max. distributed load	mm	2.2	5.1	9.1	14.2	20.5
	inches	0.08	0.2	0.35	0.55	0.8